

Product	Plastic Cassettes for Rapid Tests
Intended Use	Development/Manufacture of Lateral Flow Immunoassay Test Kit
Product Variant	Device 1, Device 2, Device 3, Device 5, Device 6, Device 9, Device 10

Physical Properties

Property	All Type
Appearance	White
Fitment	OK

Type

Type	Description
Device 1	4 mm plastic cassette
Device 2	Special 5 mm cassette with 2 holes for whole blood tests and tests requiring additional clearing buffer
Device 3	5 mm plastic cassette
Device 5	3 mm plastic cassette
Device 6	4 mm plastic cassette with 2 holes for whole blood tests and tests requiring additional clearing buffer
Device 9	5 mm plastic cassette with extra space between sample hole and window. Suitable for whole blood tests
Device 10	3.4 mm plastic cassette with extra space between sample hole and window. Suitable for whole blood tests

Specifications

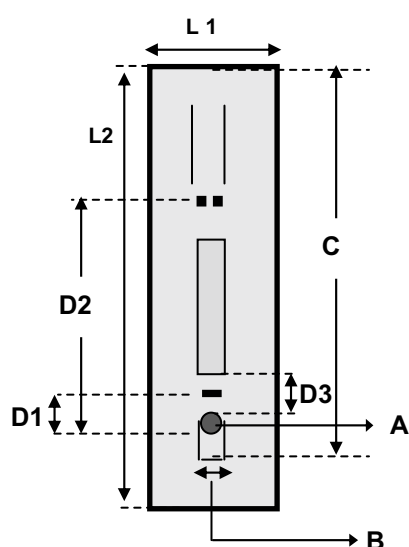

REPRESENTATIVE DIAGRAM OF PLASTIC CASSETTE - NOT TO SCALE

Parameters of Plastic Cassettes	Dimensions (mm)			
	Device-1	Device-3	Device-5	Device-9
A. Sample Hole Diameter	2.9	4.0	2.4 x 3.5	4.6 x 7.5
B. Width of Strip	4.3	4.9	2.8	4.8
C. Length of Strip	58.4	60.1	58	63
D1. Distance from sample hole to Pressure point (sample pad side)	6.7	5.9	11.8	20.5
D2. Distance from sample hole to Pressure point (Absorbent pad side)	32.5	31.6	36.9	---
D3. Distance from top of sample to start of window	11.9	10.7	15.1	17.3
L1. Width of the device	25.2	20.5	17.7	27.5
L2. Length of device	69.5	70.6	69.6	65.5
Length of window	16.8	16.8	14.0	18.9
Width of window	3.2	4.2	2.4	3.9
NC Membrane length on the strip	25	25	25	25

Specifications

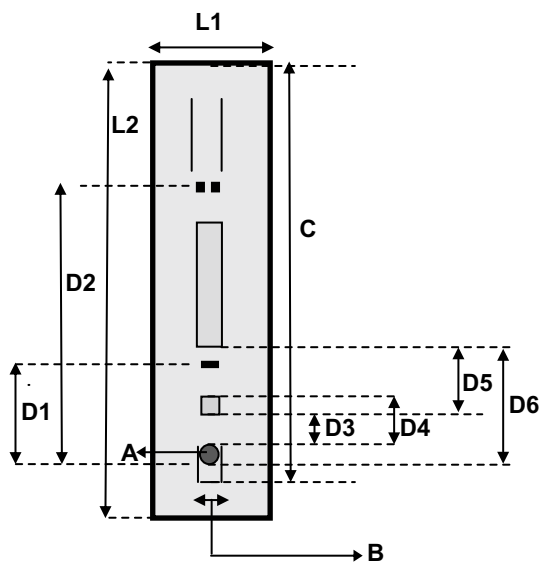

REPRESENTATIVE DIAGRAM OF PLASTIC CASSETTE - NOT TO SCALE

Parameters of Plastic Cassettes	Dimensions (mm)		
	Device-2	Device-6	Device-10
A. Sample Hole Diameter	3.9	2.6	5.2x3.1
B. Width of Strip	5.0	4.0	3.4
C. Length of Strip	80.0	78.8	60.0
D1. Distance from sample hole to Pressure point (sample pad side)	23.9	24.9	17.0
D2. Distance from sample hole to Pressure point (Absorbent pad side)	49.8	49.8	39.0
D3. Distance between sample hole and lower side of square hole	8.0	8.5	8.3
D4. Distance between sample hole and upper side of square hole	12.5	14.8	11.2
D5. Distance between lower side of square hole and start of the window	22.1	21.5	7.4
D6. Distance between lower side of sample hole and start of the window	34	33	21
L1. Width of the device	20.3	18.0	18.1
L2. Length of device	90.5	85.0	70.0
Length of window	16.0	16.0	16.3
Width of window	4	4	3
NC Membrane length on the strip	25	25	25

Storage Condition

Store and handle in accordance with all current regulations and standards.

Store in original packing at 1-35 °C. Avoid direct sunlight.

Caution: Material should be kept away from heat radiators.

Shelf Life

2 years from the date of dispatch, stored under above conditions.

Ordering Information	
Product	Quantity (Nos.)
Device 1	As per requirement
Device 2	
Device 3	
Device 5	
Device 6	
Device 9	
Device 10	
Example:	
Device 1	—